

Structural Components

CEES & ZEES
REFERENCES GUIDE

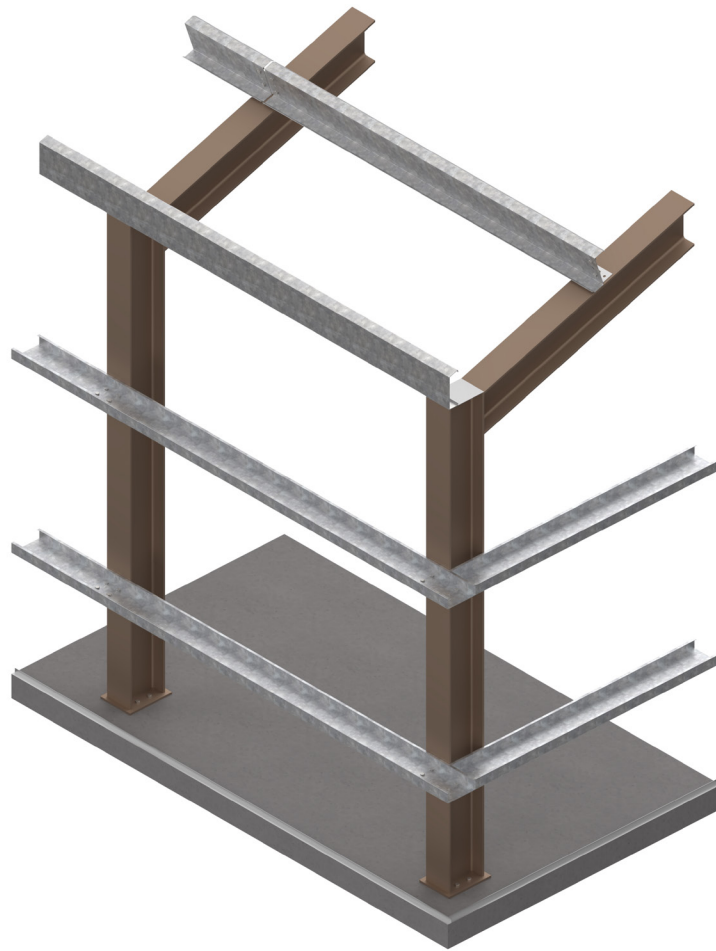

RIVERSIDE CA | SACRAMENTO CA | SALEM OR | AUBURN WA | SPOKANE WA

Table of Contents

3	Standard Cee & Zee
4-5	Standard Punching & Hole Pattern
6	Eave Struts
7	Clips & Accessories
8-10	Standard Lap Conditions
11	Common PEMB Panels
12	Terms & Conditions

Standard Cee & Zee Galvanized G-90

Standard Cee

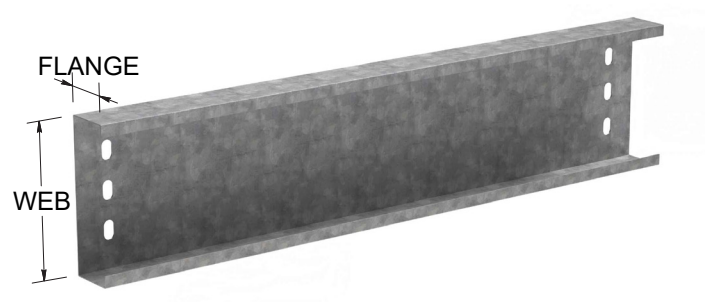

Standard Zee

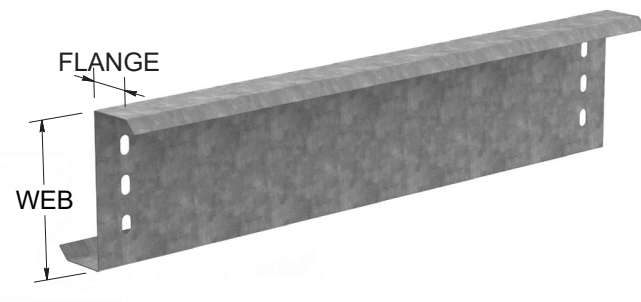

WEB	FLANGE	Gauge	Weight Per LF (LBS)	CEE Part Number	ZEE Part Number
4"	2.5"	16	2.42	PBC4x2.5-16	PBZ4x2.5-16
		14	2.84	PBC4x2.5-14	PBZ4x2.5-14
6"	2.5"	16	2.42	PBC6x2.5-16	PBZ6x2.5-16
		14	2.84	PBC6x2.5-14	PBZ6x2.5-14
8"	2.5"	16	2.82	PBC8x2.5-16	PBZ8x2.5-16
		14	3.41	PBC8x2.5-14	PBZ8x2.5-14
		12	4.92	PBC8x2.5-12	PBZ8x2.5-12
8"	3"	16	2.85	PBC8x3-16	PBZ8x3-16
		14	3.56	PBC8x3-14	PBZ8x3-14
		12	5.00	PBC8x3-12	PBZ8x3-12
10"	2.5"	14	3.90	PBC10x2.5-14	PBZ10x2.5-14
		12	5.62	PBC10x2.5-12	PBZ10x2.5-12

**Please inquire for other gauges*

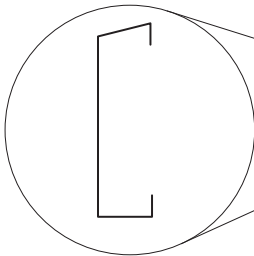

Eave Strut
(Eave Single Low shown)

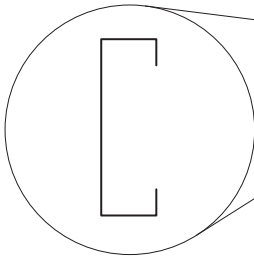

Standard Cee (Girt)

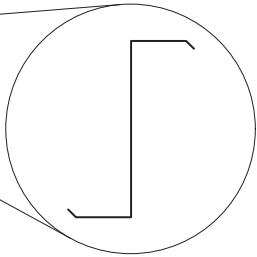
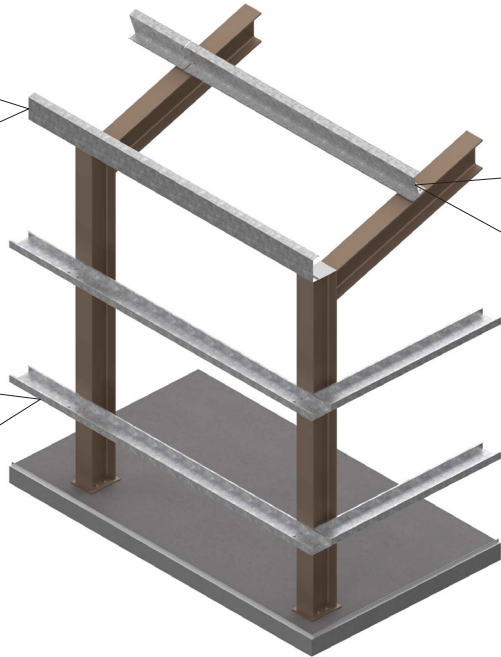

Standard Zee (Purlin)

Standard Punching and Hole Pattern

4" x 2.5" Cee

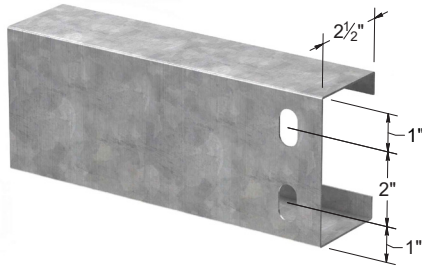

Gauge	Weight (LBS/FT)	Part Number
16	2.42	PBC4x2.5-16
14	2.84	PBC4x2.5-14

4" x 2.5" Zee

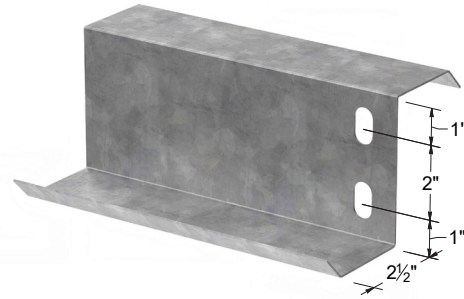

Gauge	Weight (LBS/FT)	Part Number
16	2.42	PBZ4x2.5-16
14	2.84	PBZ4x2.5-14

6" x 2.5" Cee

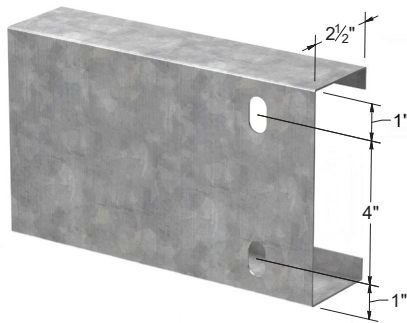

Gauge	Weight (LBS/FT)	Part Number
16	2.42	PBC6x2.5-16
14	2.84	PBC6x2.5-14

6" x 2.5" Zee

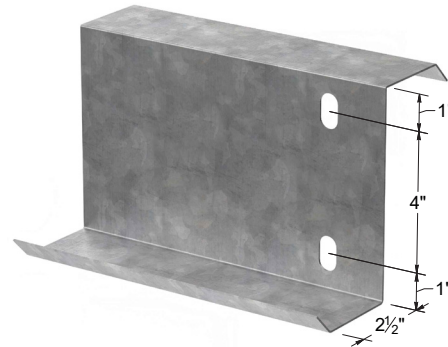

Gauge	Weight (LBS/FT)	Part Number
16	2.42	PBZ6x2.5-16
14	2.84	PBZ6x2.5-14

8" x 2.5" Cee

2 Holes available without center hole

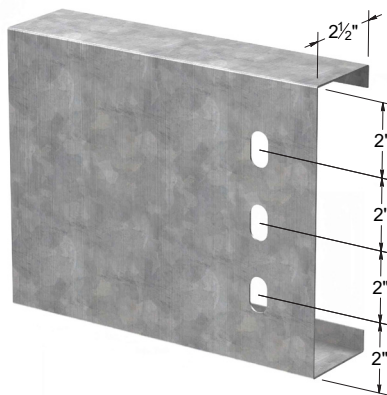

Gauge	Weight (LBS/FT)	Part Number
16	2.82	PBC8x2.5-16
14	3.41	PBC8x2.5-14
12	4.92	PBC8x2.5-12

8" x 2.5" Zee

2 Holes available without center hole

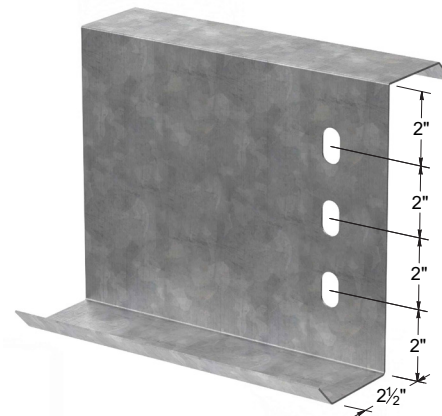

Gauge	Weight (LBS/FT)	Part Number
16	2.82	PBZ8x2.5-16
14	3.41	PBZ8x2.5-14
12	4.92	PBZ8x2.5-12

**Please inquire for custom punching*

Standard Punching and Hole Pattern

8" x 3" Cee

2 Holes available without center hole

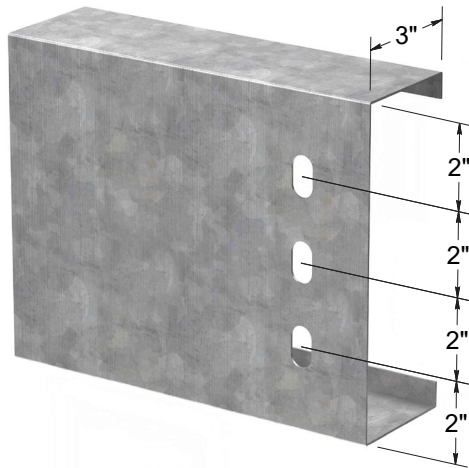

Gauge	Weight (LBS/FT)	Part Number
16	2.85	PBC8x3-16
14	3.56	PBC8x3-14
12	5.00	PBC8x3-12

8" x 3" Zee

2 Holes available without center hole

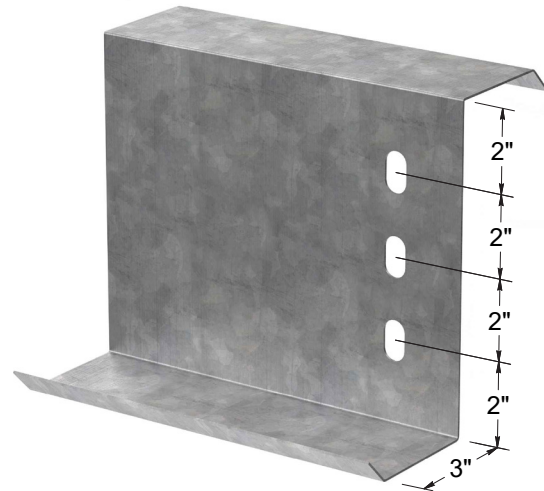

Gauge	Weight (LBS/FT)	Part Number
16	2.85	PBZ8x3-16
14	3.56	PBZ8x3-14
12	5.00	PBZ8x3-12

10" x 2.5" Cee

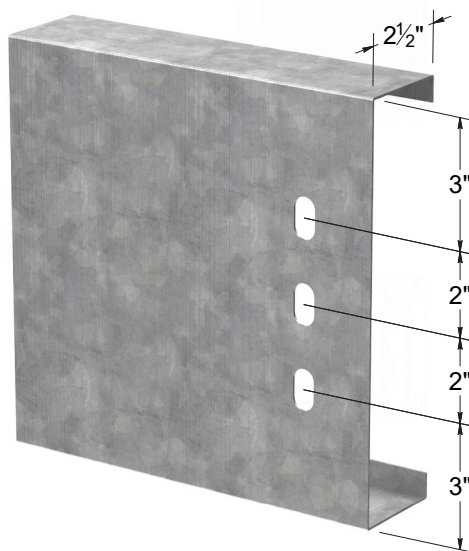

Gauge	Weight (LBS/FT)	Part Number
14	4.06	PBC10x2.5-14
12	5.63	PBC10x2.5-12

10" x 2.5" Zee

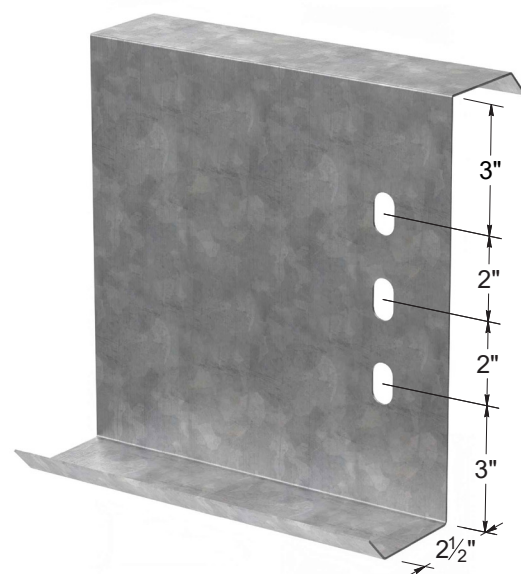

Gauge	Weight (LBS/FT)	Part Number
14	4.06	PBZ10x2.5-14
12	5.63	PBZ10x2.5-12

**Please inquire for custom punching*

Eave Struts

Eave Single Low (ESL)

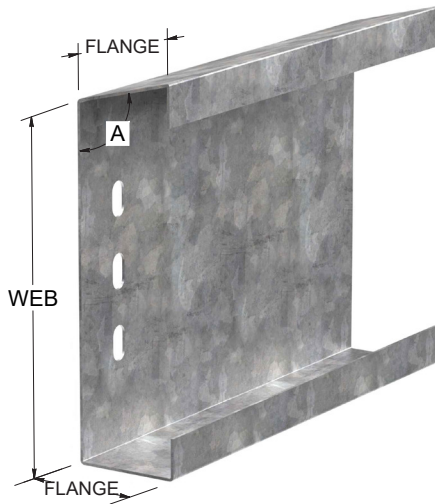

WEB	FLANGE	Gauge	Weight Per LF (LBS)	Part Number
6"	2.5"	16	2.42	PBESL6x2.5-16
		14	2.84	PBESL6x2.5-14
8"	3"	16	2.85	PBESL8x3-16
		14	3.56	PBESL8x3-14
		12	5.00	PBESL8x3-12
10"	2.5"	14	3.90	PBESL10x2.5-14
		12	5.36	PBESL10x2.5-12

Eave Single High (ESH)

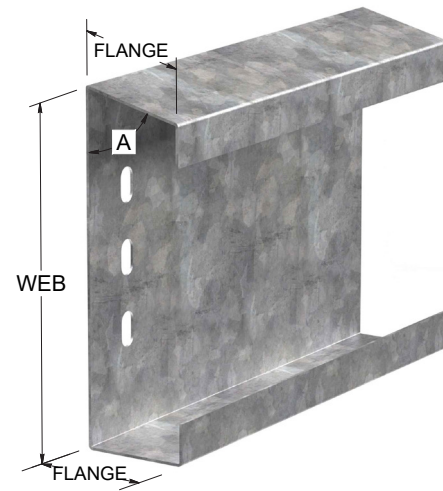

WEB	FLANGE	Gauge	Weight Per LF (LBS)	Part Number
6"	2.5"	16	2.42	PBESH6x2.5-16
		14	2.84	PBESH6x2.5-14
8"	3"	16	2.85	PBESH8x3-16
		14	3.56	PBESH8x3-14
		12	5.00	PBESH8x3-12
10"	2.5"	14	3.90	PBESH10x2.5-14
		12	5.36	PBESH10x2.5-12

Eave Double Low (EDL)

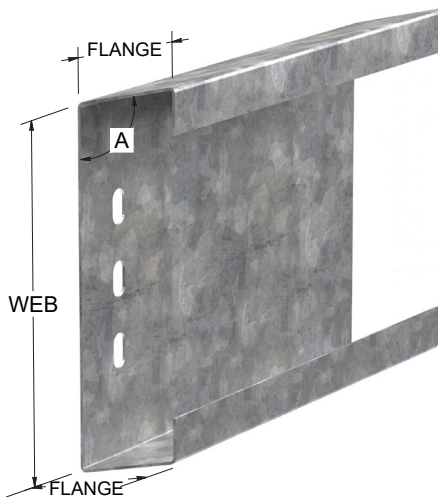

WEB	FLANGE	Gauge	Weight Per LF (LBS)	Part Number
6"	2.5"	16	2.42	PBEDL6x2.5-16
		14	2.84	PBEDL6x2.5-14
8"	3"	16	2.85	PBEDL8x3-16
		14	3.56	PBEDL8x3-14
		12	5.00	PBEDL8x3-12
10"	2.5"	14	3.90	PBEDL10x2.5-14
		12	5.36	PBEDL10x2.5-12

Eave Double High (EDH)

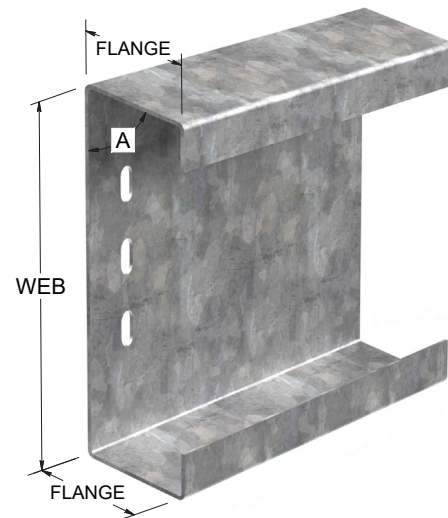

WEB	FLANGE	Gauge	Weight Per LF (LBS)	Part Number
6"	2.5"	16	2.42	PBEDH6x2.5-16
		14	2.84	PBEDH6x2.5-14
8"	3"	16	2.85	PBEDH8x3-16
		14	3.56	PBEDH8x3-14
		12	5.00	PBEDH8x3-12
10"	2.5"	14	3.90	PBEDH10x2.5-14
		12	5.36	PBEDH10x2.5-12

**Inquire for custom sizes and angles*

Clips & Accessories

6" x 3" Purlin Clip

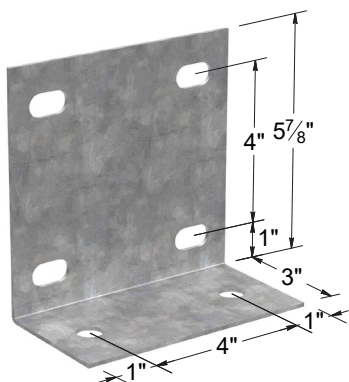

Gauge	Weight (LBS/FT)	Part Number
12	1.48	APC6x3-12

8" x 3" Purlin Clip

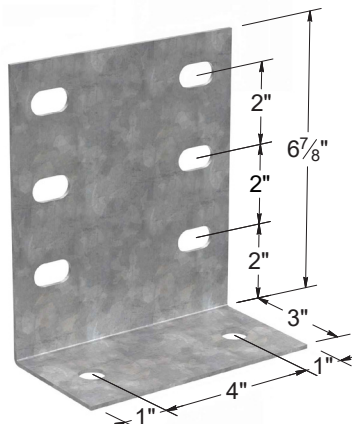

Gauge	Weight (LBS/FT)	Part Number
12	1.65	APC8x3-12

10" x 2.5" Purlin Clip

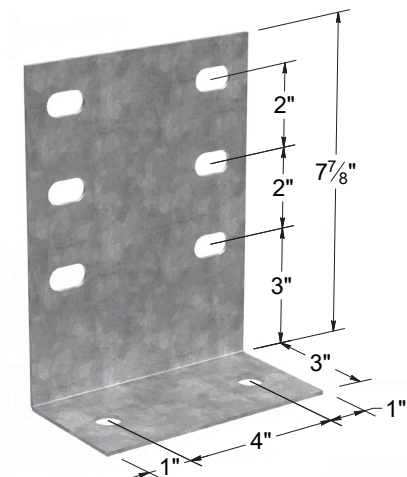

Gauge	Weight (LBS/FT)	Part Number
12	1.65	APC10x2.5-12

Welded Purlin Clip

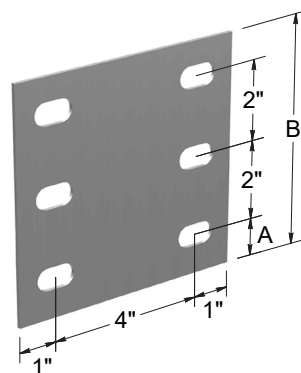

Gauge	A Dimension	B Dimension	Weight (LBS/FT)	Part Number
12	1"	5 7/8"	0.98	APCW6x3-12
12	2"	6 7/8"	1.15	APCW8x3-12
12	3"	7 7/8"	1.31	APCW10x3-12

Bolt and Nut and Washer

- sold by the box
- A 325 1/2" x 1-1/4"

A325 1/2" x 1-1/4" Bolt



A325 1/2" Nut

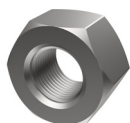

1-1/2" Fender Washer



Note: Additional sizes available. Bolts, nuts, and washers sold separately.

Standard Lap Conditions

Simple Span

Front View

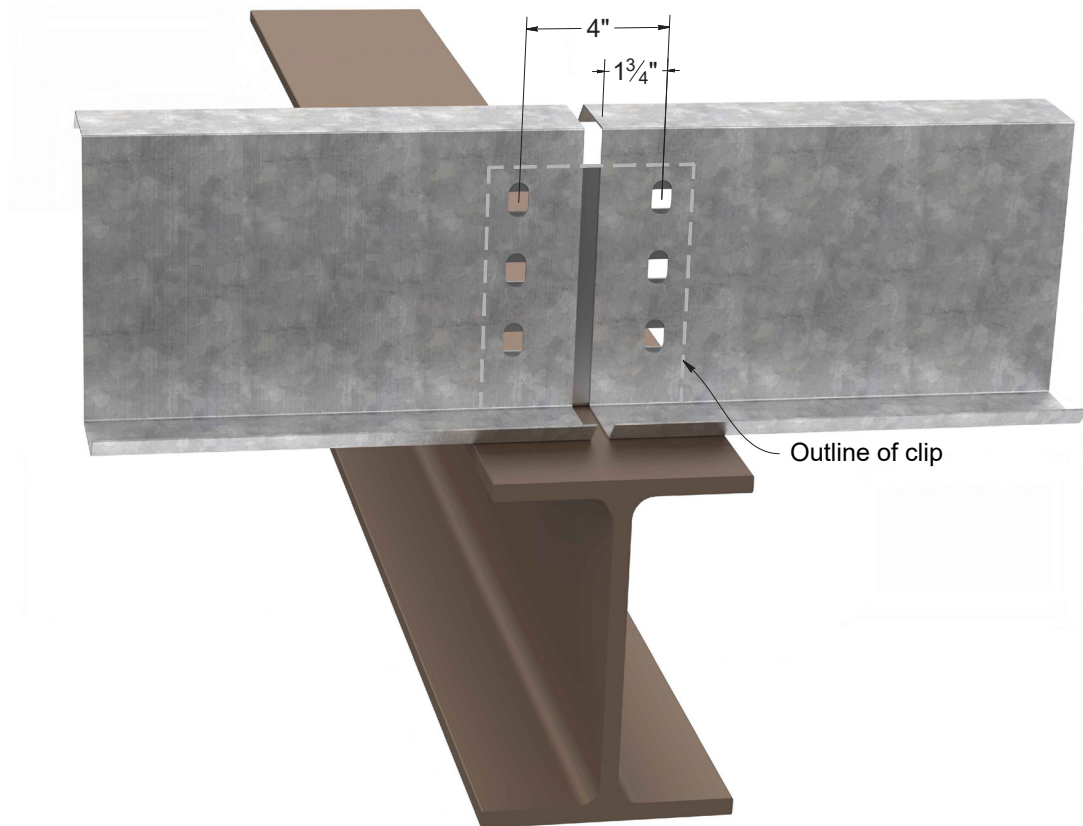

Note:

- Circular holes measure: 1/2", 5/8" or 11/16"
- Oval-shaped holes measure: 9/16" x 1" or 3/4" x 1"

Order Information:

1. To determine actual order length, subtract 1/2" from bay spacing.
2. To determine end bay actual order length, subtract 1/2" from bay spacing.

Back View

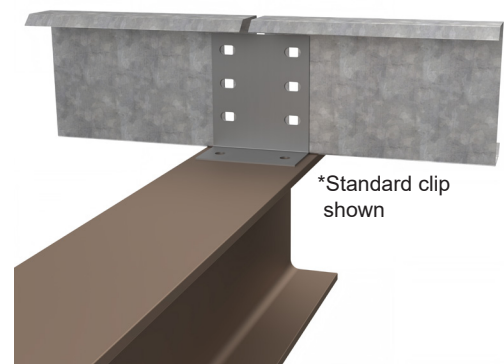

Standard Lap Conditions

Short Lap “Type SL”

Front View

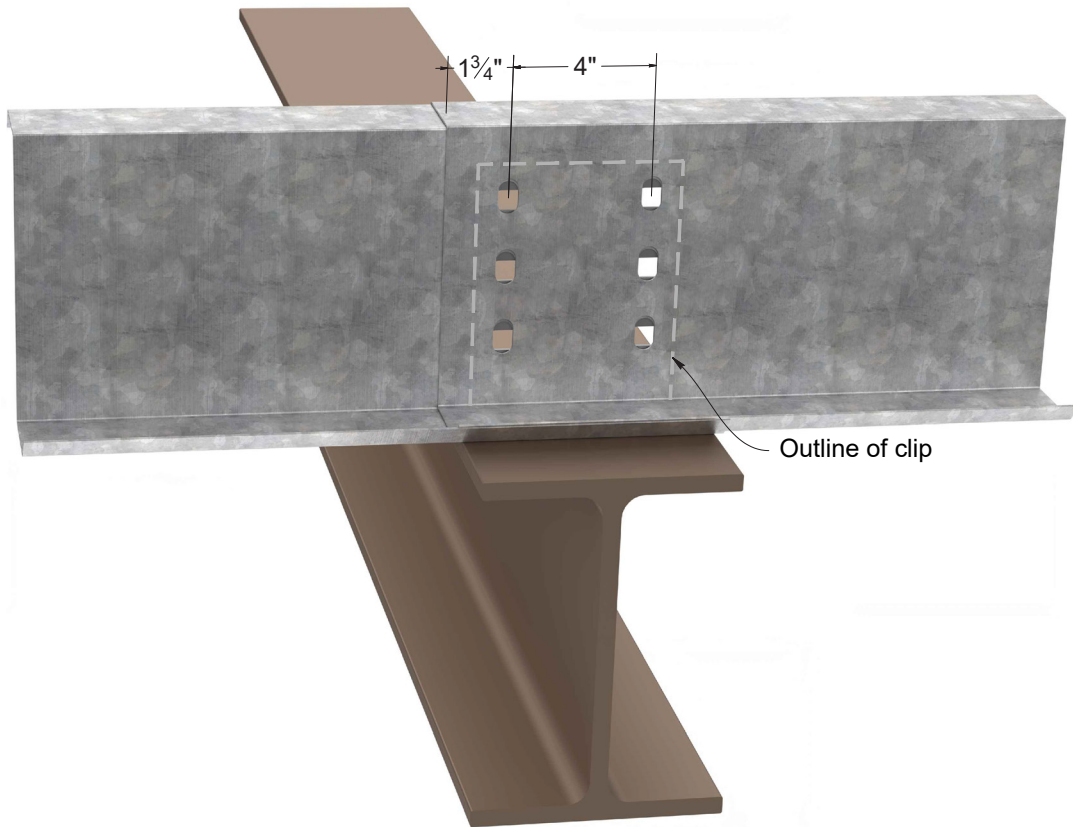

Note:

- Circular holes measure: 1/2", 5/8" or 11/16"
- Oval-shaped holes measure: 9/16" x 1" or 3/4" x 1"

Order Information:

1. To determine actual order length, add 7-1/2" to bay spacing.
2. To determine end bay actual order length, subtract 1/4" for setback, then add 3-3/4" to bay spacing.

Back View

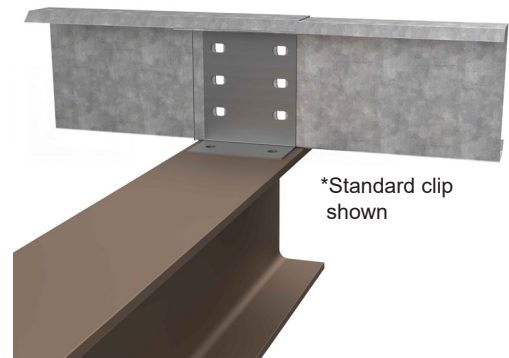

Standard Lap Conditions

Long Lap “Type LL”

Front View

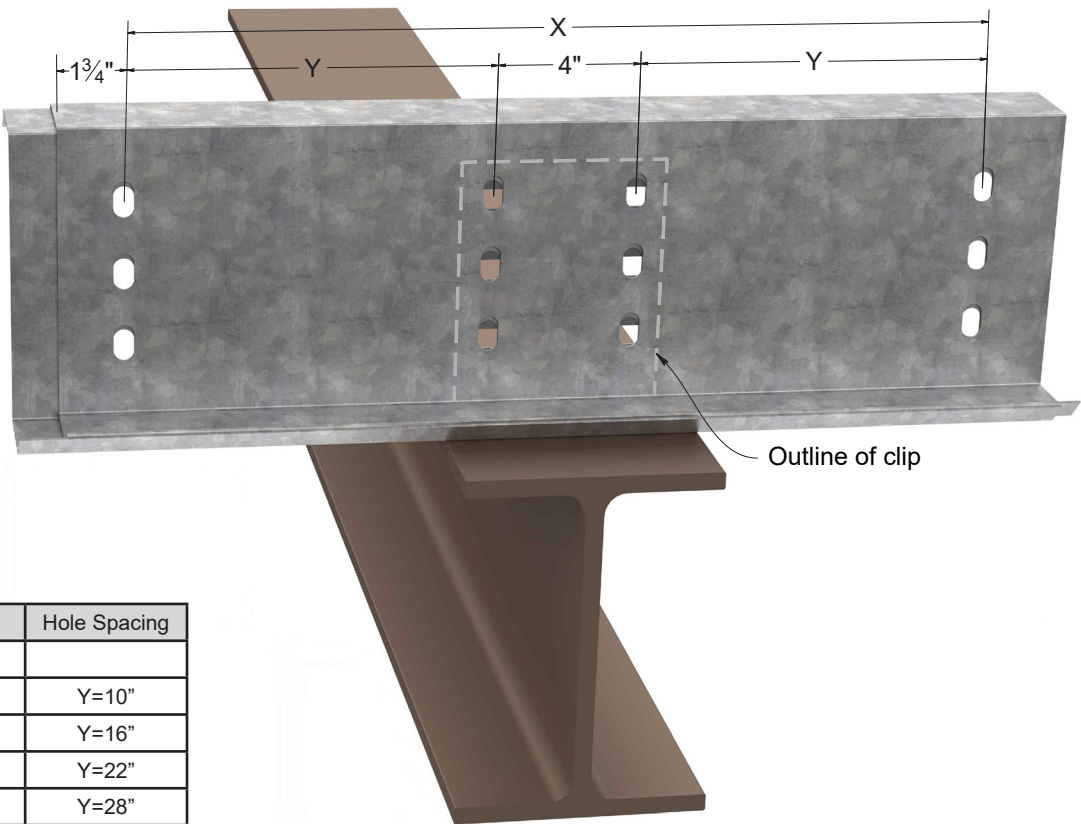

Lap Length	Hole Spacing
X=12"	
X=24"	Y=10"
X=36"	Y=16"
X=48"	Y=22"
X=60"	Y=28"

Note:

- Circular holes measure: 1/2", 5/8" or 11/16"
- Oval-shaped holes measure: 9/16" x 1" or 3/4" x 1"

Order Information:

1. To determine actual order length, add 2' 3-1/2" to bay spacing.
2. To determine end bay actual order length, subtract 1/4" for setback, then add 1' 1-3/4" to bay spacing.

Back View

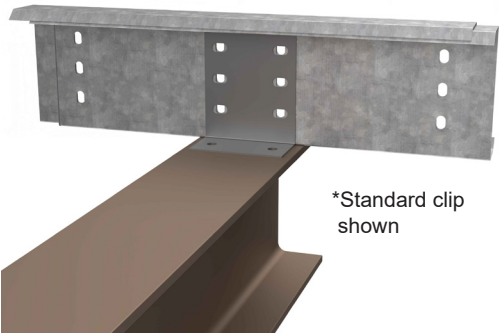

Common PEMB Panels

PEMB Panels - available in 26ga ArmorTech™ & 24ga Kynar 500® PVDF Resin

PBR

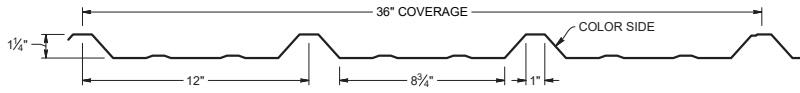

Marion "R" Panel™

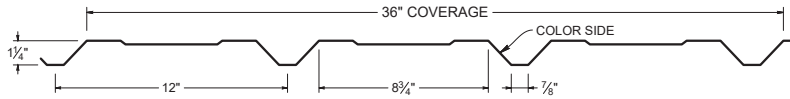

Tuff Rib

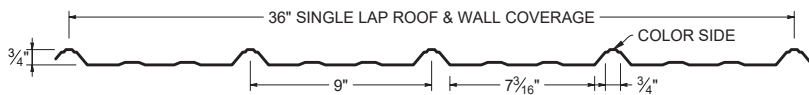

T-3™

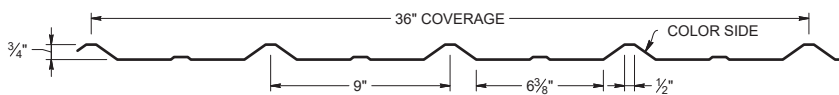

GR-7™

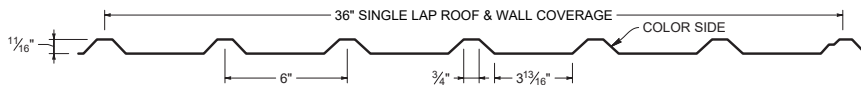

HR-34™

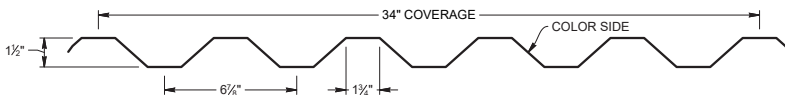

Classic 7/8" Corrugated™

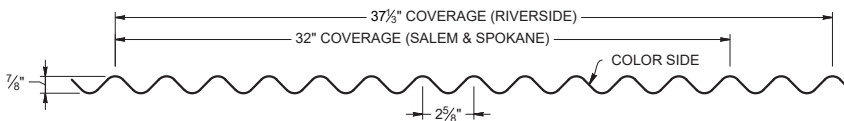

#12 Tek Self Driller with Neoprene Washer



#12 Tek Screw Hex Head



#14 x 7/8" Lap Tek Stitch



24GA MS-200™ - only available in Kynar 500® PVDF Resin

MS-200™



Standoff Clip

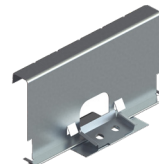

#10 x 1" Pancake Quadrex Head Tek Self-Driller



PVDF is a fluoropolymer that is manufactured under the trademarked names Kynar 500® and Duranar (PPG). Paint finishes containing a minimum 70% PVDF resin meet the high-performance weathering criteria established by the American Architectural Manufacturing Association and are allowed to carry the Kynar500® trademarked name. Zincolume® & Zincolume® Plus are registered trademarks of Bluescope Ltd. Galvalume® is a registered trademark of BIEC International, Inc. Vintage® is a registered trademark of Steelscape, Inc. Kynar® and Kynar 500® is a registered trademarks of Arkema, Inc.



Terms & Conditions

Products identified in this brochure ("product/s") are manufactured and designed for multiple purposes, and should only be used in applications as specified by a qualified architect or engineer. Product modifications or changes in installation procedures should only be done after consultation with a qualified architect or engineer. **Taylor Metal, Inc.** (hereinafter referred to as TMP), is not responsible for damages, claims, or losses resulting from improper installation or unapproved alterations of the product. You should consult with your contractor and/or architect or engineer to obtain appropriate engineering and application specifications prior to the installation of any project.

Products and loads specified in this brochure are subject to the described specific applications and proper installation. Modified products, incorrect loading methods or installation procedures, or any other applications will impact the product's load capacities. Exposure of the product to chemicals, fertilizers, or other corrosive materials or environments may affect the galvanizing properties of the product. TMP reserves the right to make changes or corrects to this brochure and the product's specifications at any time. All product sales are subject to these Terms, Conditions, and Return Policy.

RETURN POLICY: This product is custom manufactured for each job and therefore can not be returned. All sales are final.



RIVERSIDE CA | SACRAMENTO CA | SALEM OR | AUBURN WA | SPOKANE WA

WWW.TAYLORMETAL.COM

Other Taylor Metal companies:



In partnership with:

